



Follow us



@theNPMS

@the\_npms

NPMS Support

## Monitoring change in UK habitats

- 3 survey levels
- 2 surveys per year
- 5 plots per 1km<sup>2</sup>
- Positive and negative indicators



## Using NPMS data: UK Plants and Climate

### Change/Extreme Weather

Research is currently underway looking at the exposure of UK habitats to past and future climate change and looking at how plant communities have responded. During this year of climate and biodiversity focus (COP26 and CBD) it would be fantastic to get as many botanists involved in collecting data that can contribute to this work.

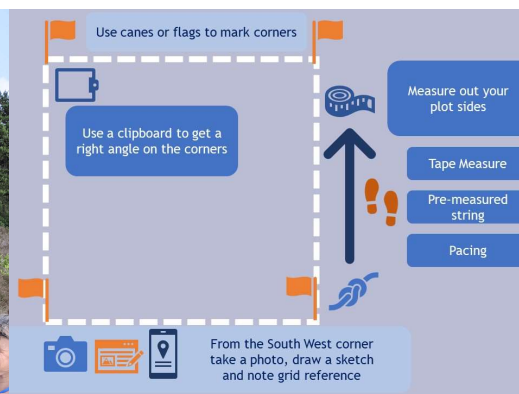

## How can you get involved?

Only **2** surveys a year across up to **5** small plots! Can you spare that time? We provide all the training and materials, including video guides. Find out if there is a square near you or maybe a favourite place you visit further afield that has a square? Contact us if the square you want is already taken as it might still be available.

Or could you spare time to take some NPMS volunteers out on their squares local to you? Our volunteers are all keen but their experience ranges from beginner level up to experienced botanists. The scheme is popular as you can record at three different levels.

### BE PART OF SCIENCE IN ACTION

#### National Biodiversity Indicator

C7. Plants of the wider countryside

This indicator measures change in the abundance (% cover) of plant species that are used to assess a healthy habitat in the UK.

Arable field margins

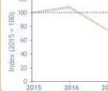

Bog and wet heath

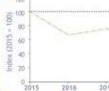

Broadleaved woodland & hedgows



Lowland grassland



UK Centre for Ecology & Hydrology



JNCC



Botanical Society of Britain & Ireland

## The partnership



Northern Ireland Environment Agency  
[www.daera-ni.gov.uk](http://www.daera-ni.gov.uk)



An Agency within the Department of Agriculture, Environment and Rural Affairs  
[www.daera-ni.gov.uk](http://www.daera-ni.gov.uk)