



Our land abounds in

Nature Strips

Of beauty rich and rare?

Dr Rob Saunders

Bayside's Nature Strips

- Total area larger than Sandringham Golf Course
- Width ranges from ~1 m to > 6 m
- Variations in length, slope, orientation, light
- Mostly mown grass, often weedy
- Most dwellings also have one street tree

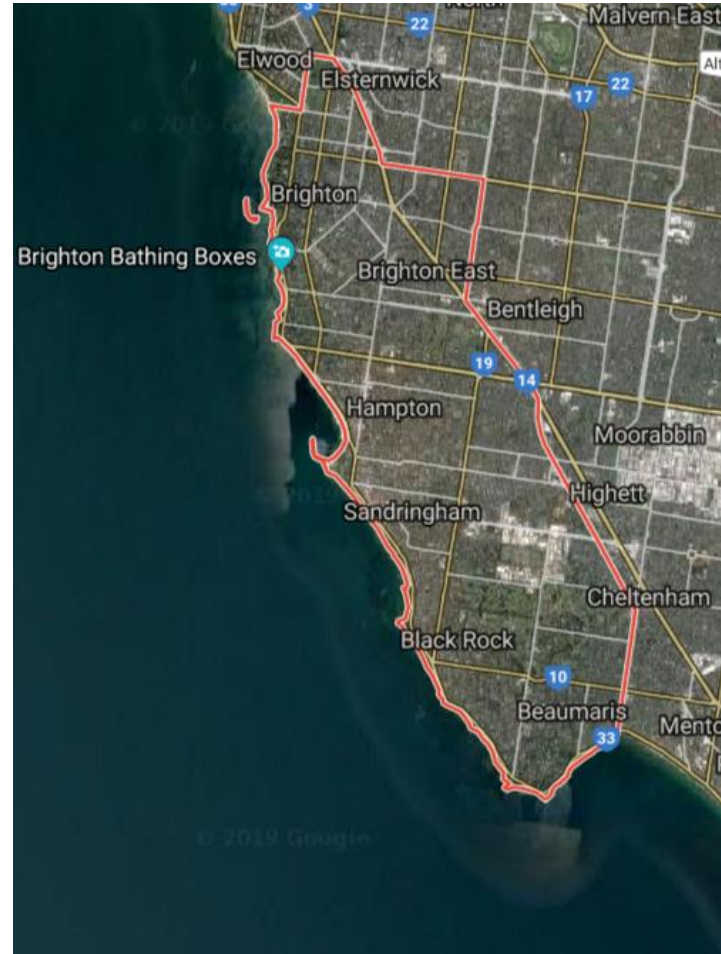

Bayside Council encourages *...appropriate* Nature Strip planting

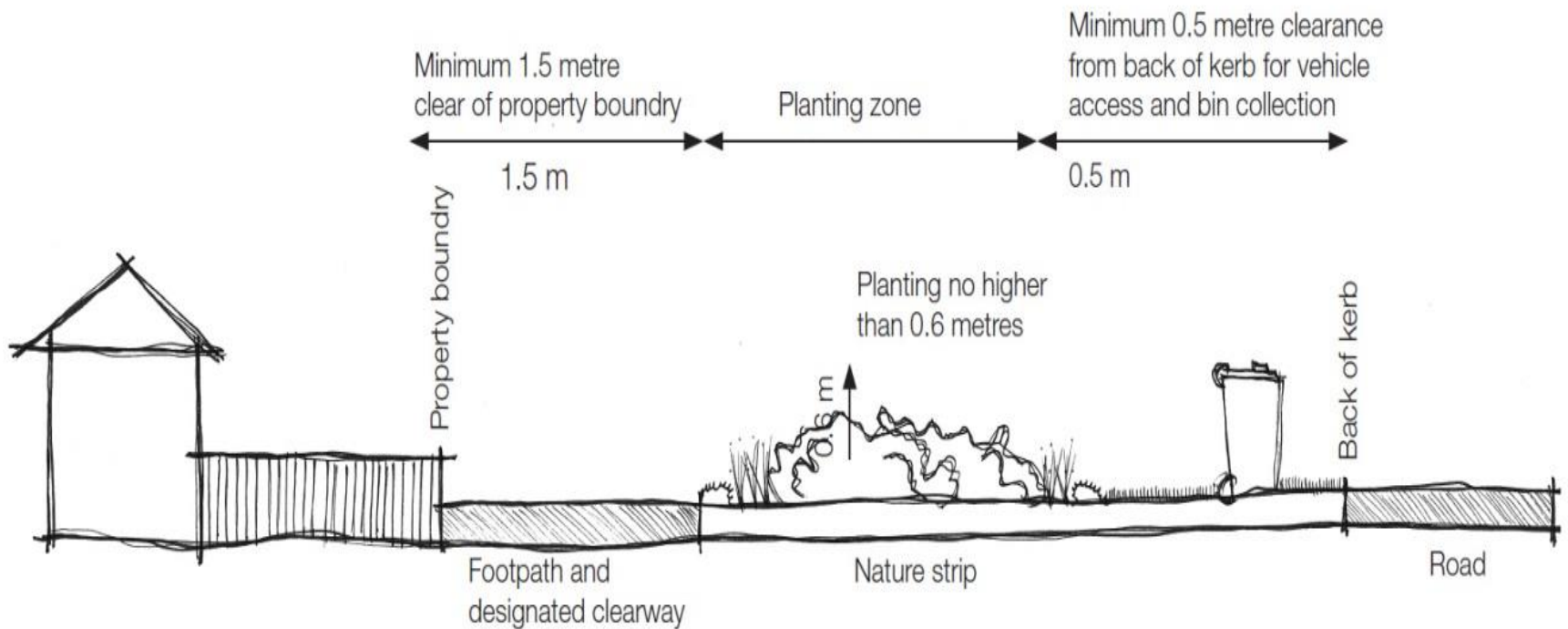

General guidelines

- Keep plants low for visibility and safety
- Avoid damaging pipes, underground wires etc
- Take special care on corners
- Leave space for access (cars, bins etc)
- See Bayside Council website for detail:
<https://www.bayside.vic.gov.au/how-plant-your-nature-strip>
- Leave tree planting to Council...

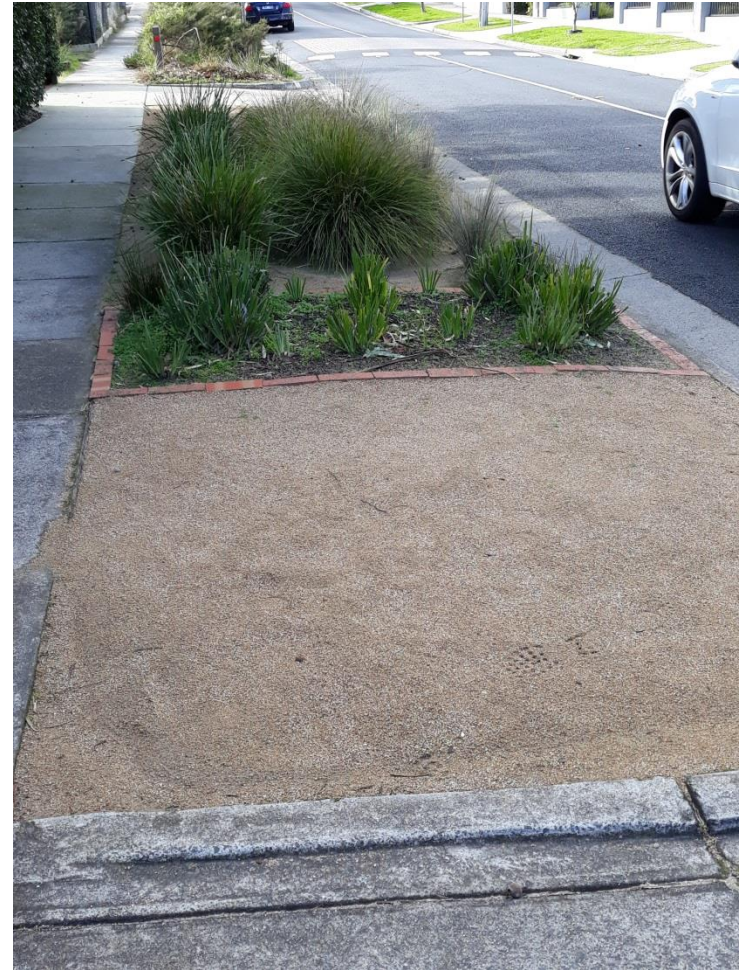

Would you like a tree?

bayside.vic.gov.au/request-new-nature-strip-tree



Services ▼

Payments ▼

About Bayside ▼

Contact



[Home](#) > [Request a new nature strip tree](#)

Request a new nature strip tree

Your Details

☐ I wish to remain anonymous

Title *

- Select - ▼

First Name *

Last Name *

Your Address

Address *

Bayside Community Nursery

- Grows only local (indigenous) plants
- Not-for-profit (for conservation)
- Open 10 -12 Thursday, Saturday early April – end October
- Extensive range (~150 sp)
- Helpful volunteers (come and join us?)
- Tube stock very cheap
- Coastal vs inland species
- Tolerance: dry vs swampy
- Take photos of nursery plant labels (avoids using plastic, cuts costs)



Selecting suitable plants

- Many suitable indigenous plants
- Some like full sun
- Most take some shade
- Not many need full shade
- Many local plants are drought-hardy once established
- Ground covers and low shrubs are best for nature strips

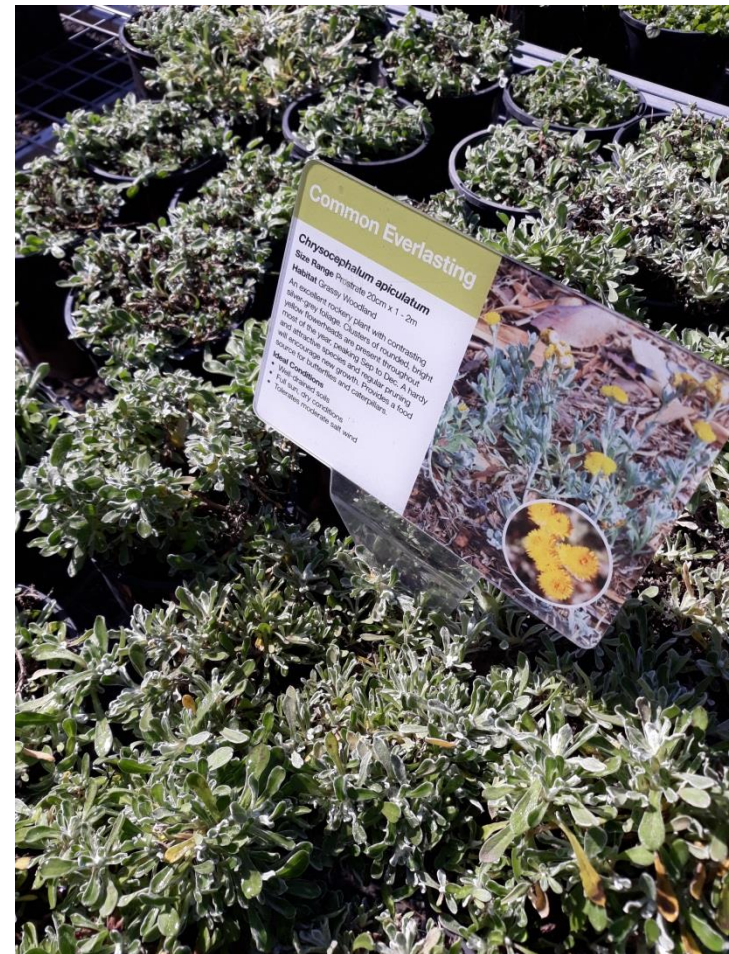

Nursery Display Gardens

- Lots of plants on-site
- Bushland Reserves also great spots for ideas
- If you like something, take a photo (we can identify)
- Many great plants are little known
- No mowing, little weeding
- Some watering to establish plants



Design Hints

- Try local grasses and lawn substitutes
- Use lawn, woodchips or gravel on heavy use areas
- Keep it simple: 5 – 8 species is ample
- Foliage colour contrast
- Cluster main plantings for ease of maintenance
- Use tussocks, ground covers and low shrubs



Best planting season?

- Autumn, winter, spring
- NOT summer
- Ideal: topsoil moist but not cold
- Nursery opens in April (widest choice)
- Closes end October
- Summer is about survival



Preparation and care

- Always dig in organic material (humus)
- NO fertilisers!
- Watch for *hydrophobic soils* (use Wettasoil granules)
- Do some watering to establish plants
- Weed regularly
- Tidy plants after growing seasons (spring, autumn)



Plants for dry spots

- Sunny dry spots:
 - Spear Grass
 - Wallaby Grass
 - Tussock grass
 - Kangaroo Grass
 - Karkalla (*Carpobrotus*)
 - Common Everlasting
 - Mat-rush (*Lomandra*)
- Shady dry spots:
 - Flax-lily (*Dianella*)



Plants for moist or shady spots

- Moist spots:
 - Native Violet
 - Lobelia
 - Knobby Club-sedge
- Shady spots:
 - Kidney Weed (*Dichondra*)
 - Running Postman
 - Raspwort (*Gonocarpus*)
 - NZ Spinach (*Tetragonia*)
 - Bracken fern

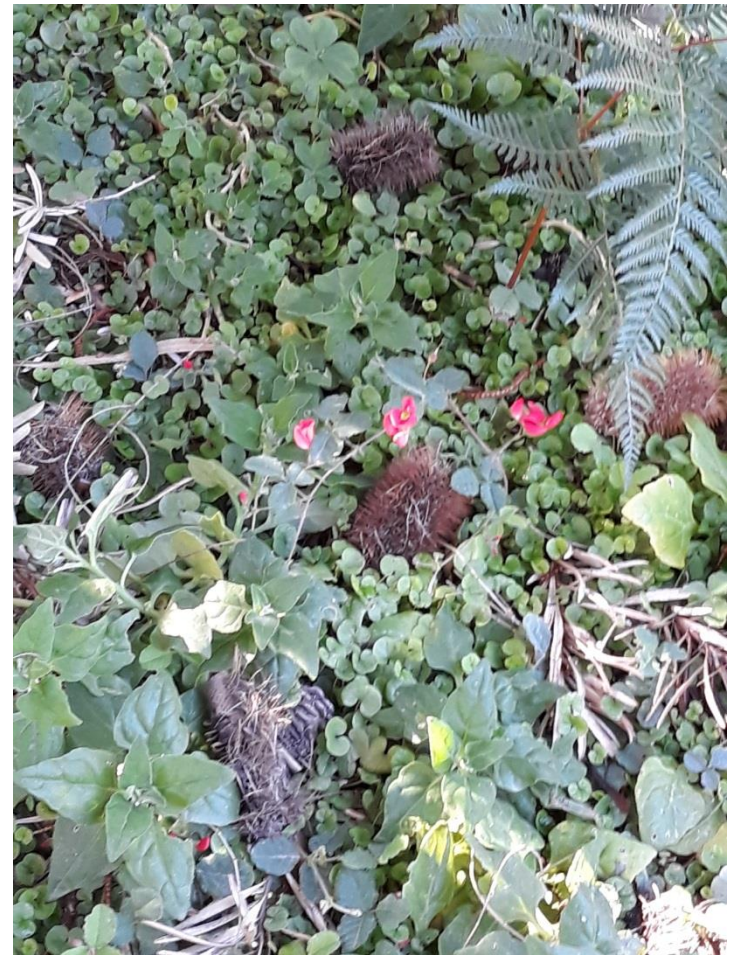

Generic nature strip design ideas

- Use lawn substitutes
 - Access areas
 - Utility spaces (bins etc)
- Clump plantings
 - Define spaces
 - Retain access routes
- Cut and paste to suit
 - Move sections to fit your driveway position etc
 - Blue grid lines every 3 m

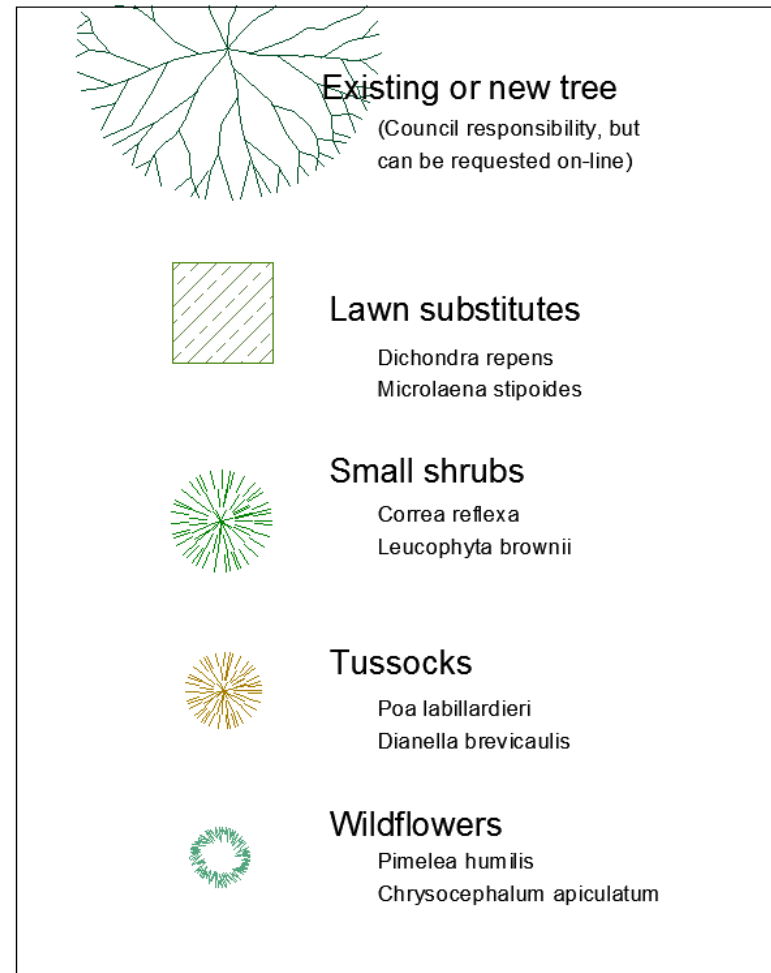

Example of the generic plan

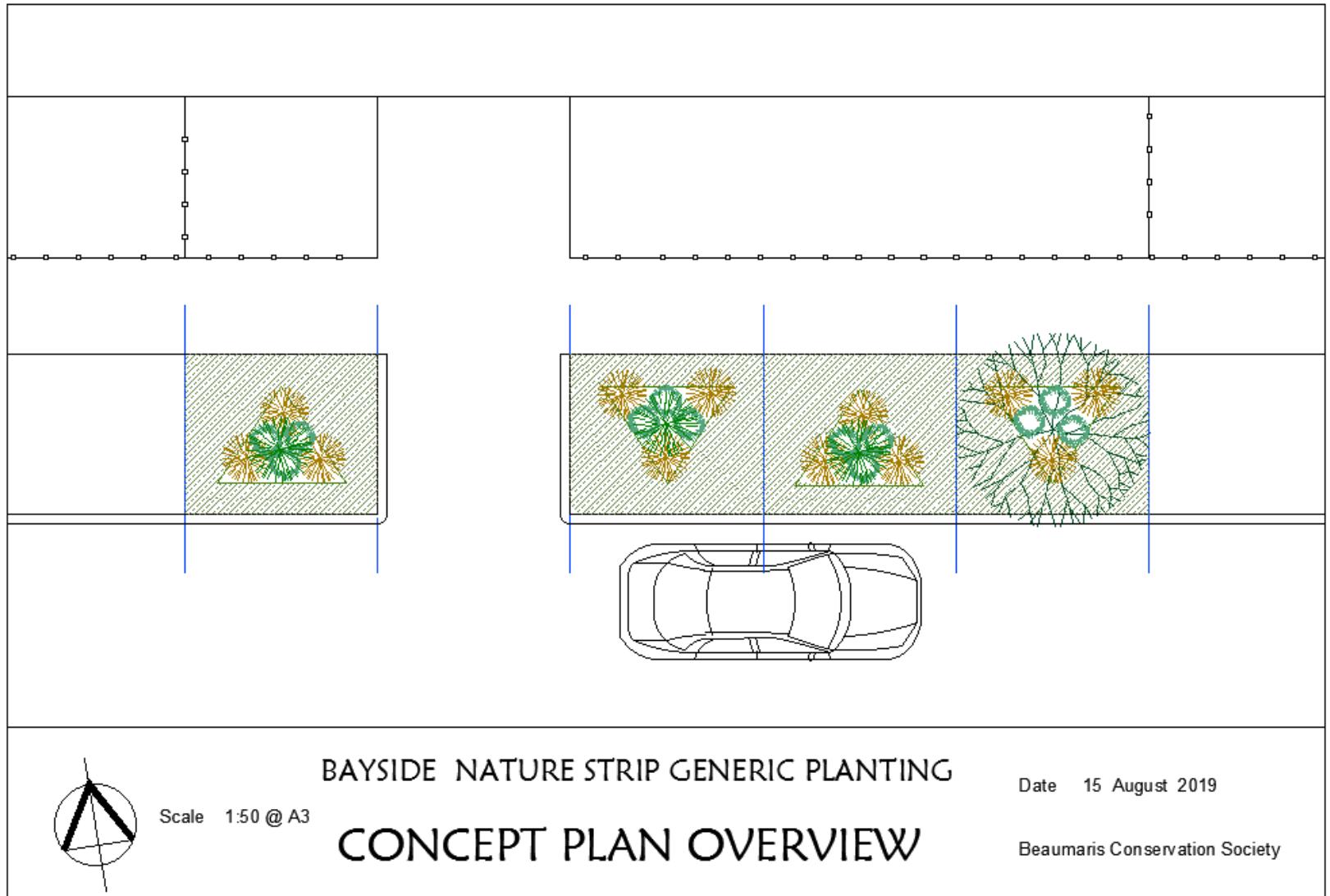

Cost and implementation

- Council approval
 - No fee
 - Process usually 2 weeks
- One triangle at a time \$30
 - 10 plants x \$2.35 = \$23.50
 - 1 bag of potting mix \$6.50
- Lawn substitute plants
 - 4 plants per sq m will spread over time
 - 25 sq m = 100 plants
 - Wholesale discount price \$1.50 per tube = \$150

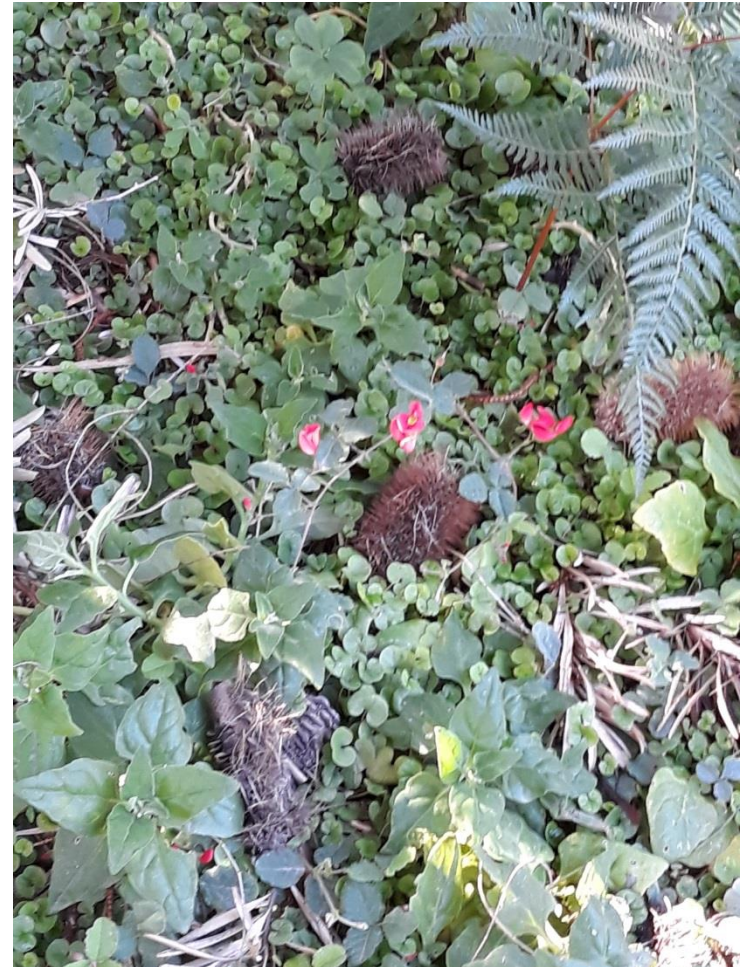

A photograph of a garden bed with mulch and green plants, with a large white text overlay reading "Questions?". The background shows a fence and trees.

Questions?